

Planet F140 flat threshold

Thermally separated | → 138 x 8,5 mm

DOOR MATERIAL

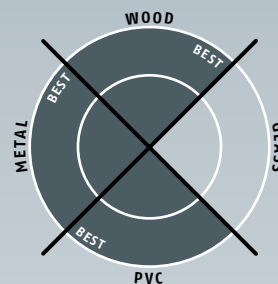

Main features

- Thermally broken flat threshold
- Optimal transition between inside and outside
- Barrier-reduced height
- Stable and can be ridden over
- For renovations and new builds
- Adhesive mounting
- An even block surface for all Planet drop-down seals for an optimal sound protection.
- With four adhesive cement grooves for an enlarged surface to make sure an optimal bond
- In combination with Planet X3 guaranteed impermeable to driving rain

Versions

- Surfaces: silver anodised EV1 (aluminum)

Assembly

Affix onto a surface free of dust or grease with normal building adhesive



Door types with Planet F140

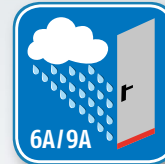

More functions

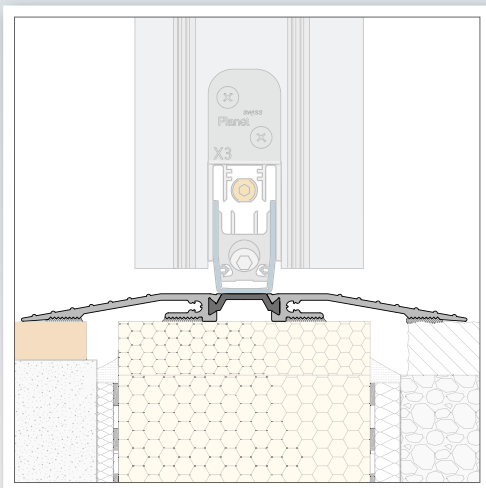

Technical specifications

Profile material	aluminium, → width 138 mm
Height	8,5 mm
Finish	silver anodised EV1 (aluminum)
Lengths in stock	710, 835, 960, 1085, 1210, 1250, 1335, 1460, 1585, 1710 mm
Special lengths	up to 6000 mm
Can be shortened	yes
Thermal separation	yes
Fastening	with normal building adhesives

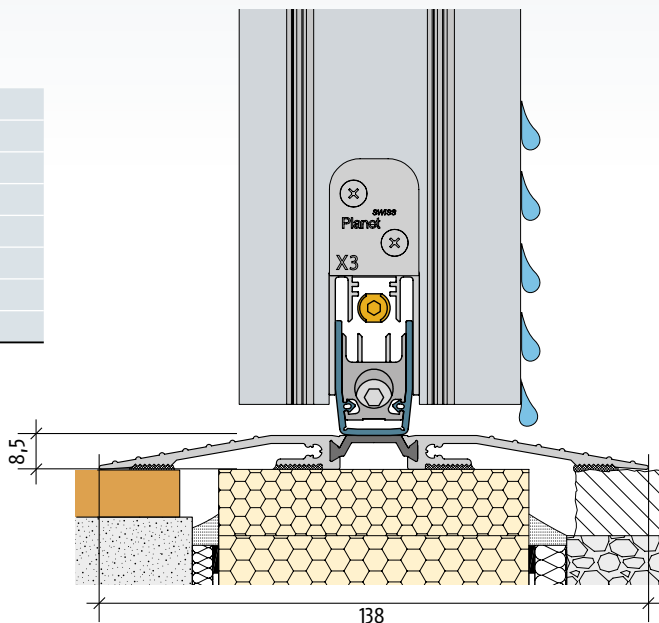

Planet F140 flat threshold

Application for new buildings

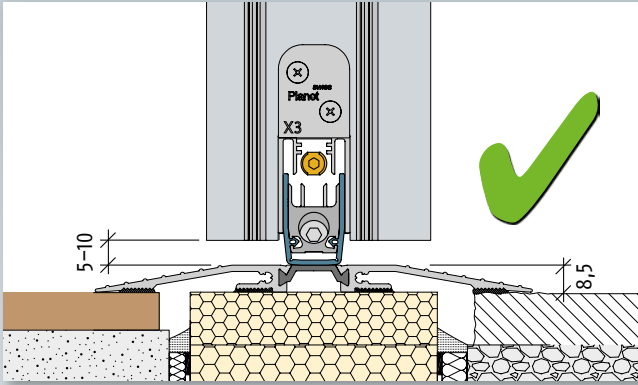

New building with thermal separated flat threshold F140 and Planet X3

Application for renovation

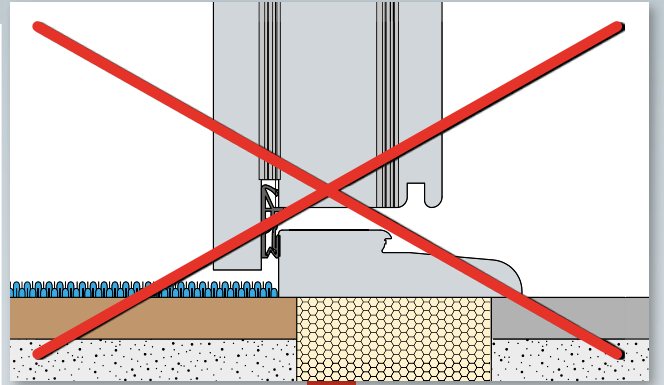

No step to trip over

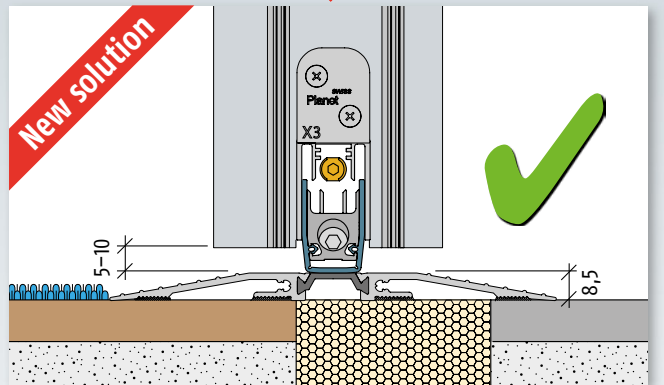

Renovation with thermal separated flat threshold F140 and Planet X3

Order specifications

Planet F140	Prod. code 252xxx*
--------------------	--------------------

* xxx = refer to price list for profile length

Accessories | Options

Cut the Planet to fix dimension	Prod. code 900200
Planet X3 → RD ← 52 dB trimmable incl. Planet set for shortening X3 and assembly set X3 for wooden doors	Prod. code 200xxx*
Planet X3 → RD ← 52 dB made to measure, ready for installation incl. Planet assembly set X3 for wooden doors	Prod. code 203xxx*
Planet corner plate set X3, aluminim	Prod. code 900136
Planet corner plate set X3, sheet metal (Type 1; width 29 mm)	Prod. code 900137
Planet corner plate set X3, sheet metal (Type 2; width 39 mm)	Prod. code 900954
Planet corner plate set X3, sheet metal (Typ 3; width 49 mm)	Prod. code 900955

Advertising text



Planet F140 flat threshold → thermal separation
Thermally broken flat threshold **Planet F140** (138 x 8,5 mm) suitable for even transitions. Optimal transition between inside and outside. Adhesive mounting, silver anodised EV1 (aluminum). With four toothed adhesive cement grooves for an enlarged surface to make sure an optimal bond.