



MEDIATOR®  
Technical information



## MEDIATOR®: the ideal lock solution for apartment buildings and for commercial and public buildings

MEDIATOR® was originally developed as the perfect lock solution for the entry door to apartment buildings, where it provides high intrusion protection, a safe escape route and convenience. Due to the great success in this area, however, increasing numbers of security companies, installation companies and metal and wood processing companies recognise MEDIATOR® as the standard product for numerous door situations with similar requirements.

Therefore, as multifunctional door locking, MEDIATOR® is used in the widest range of branches, institutions and sectors. It can be found wherever a door must reliably lock again after entry: Side entries, personnel entries, doors to server rooms, entrance doors to medical practices and law offices, access to management or personnel departments – the application possibilities for MEDIATOR® are practically unlimited.

### The most important advantages in apartment buildings

- High intrusion protection, because the main entrance is always locked.
- Safe escape route, because the building can be left through the main entrance.
- Great convenience, because the locked main entrance can be opened from inside the apartment.

### The most important advantages in public and commercial buildings

- MEDIATOR® can be combined with EAD and intrusion alarm systems.
- MEDIATOR® has all important certifications and approvals
- MEDIATOR® can also be used in fire and smoke protection doors in coordination with the door manufacturer.



### Certified security: MEDIATOR® has all important certifications and approvals

- VdS approval as lock monitoring means VdS Class C, G 109 032
- VdS approval as mechanical locking means VdS Class A, M 109 314
- VdS Approval as an electromechanical actuator for access control systems VdS Class C, Z 109 001
- Approval in compliance with DIN EN 179, as an emergency exit door lock
- Approval in compliance with DIN EN 1125, as a panic door lock
- Inspection authority test certificate for use in fire and smoke protection doors No. 120003555

MEDIATOR® satisfies interests in many different areas. And what's more, the cost is up to 50 percent lower than for comparable systems.



Mediator®

## the advantages on every door: always locked automatically

Whether in an apartment building or commercial and public buildings: the most important function for the responsible parties is automatic locking after entry. Therefore, with the use of MEDIATOR® the security aspect always comes first, regardless of the reasons. The same applies for medical practices and law offices, as well as for office buildings with several tenants, jewelry business and archives, for clinics and production

halls or for large projects with several entrances. The function to be performed by MEDIATOR® can be determined specifically for each case.

Some application examples MEDIATOR® can be found here.

### **MEDIATOR® for apartment buildings**

The unique and perfect solution for the main entrance which fulfils all requirements with respect to security and user convenience. MEDIATOR® solves conflicts of interest for residents and building management alike and provides peace of mind in the building.



### **MEDIATOR® law offices**

A safe and user-friendly solution for law office employees and clients alike.

Visitors arriving outside of office hours can ring the doorbell and be let in with a release button. The offices can be left at any time and the door is immediately locked again.



### **MEDIATOR® for the server room**

As a VdS-certified locking element, MEDIATOR® in combination with an access control system offers reliable security, determining who may enter this sensitive area and ensuring that the door always locks again afterwards.



### **MEDIATOR® for production halls**

Production halls often have auxiliary, side or rear doors that are used only sporadically or never at all. MEDIATOR® also provides the assurance in this case that the door always remains locked, but the escape route is always free.



## the System

### Lock, electric strike, power supply

**An ideal combination:**  
**Ingenious ideas and the latest door technology.**

The most brilliant of ideas are usually also the simplest ones. MEDIATOR is based on a combination of a self-locking escape door lock with an electric strike. The lock is a specially adapted variant of the proven effeff model 309X in single or multi point version. The MEDIATOR® electric strike is a new development designed especially for this locking solution. Different power supply units are available for surface or flush mounting. Complete system accessories for fast, professional fitting rounds off the MEDIATOR® lock solution.

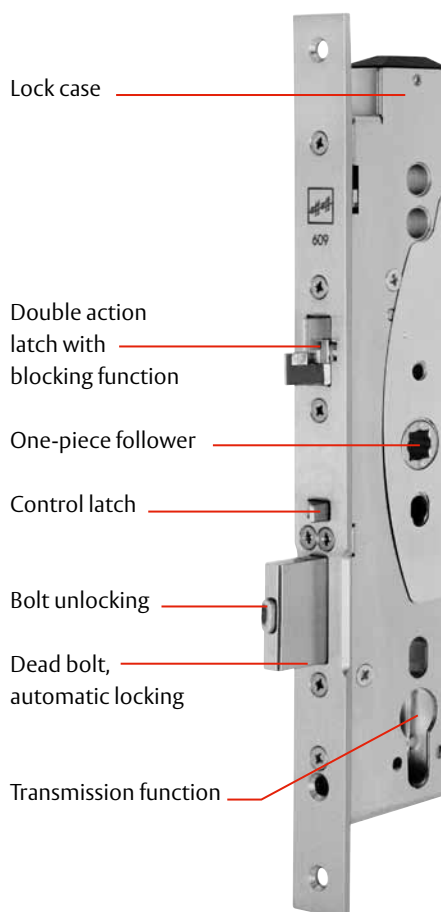
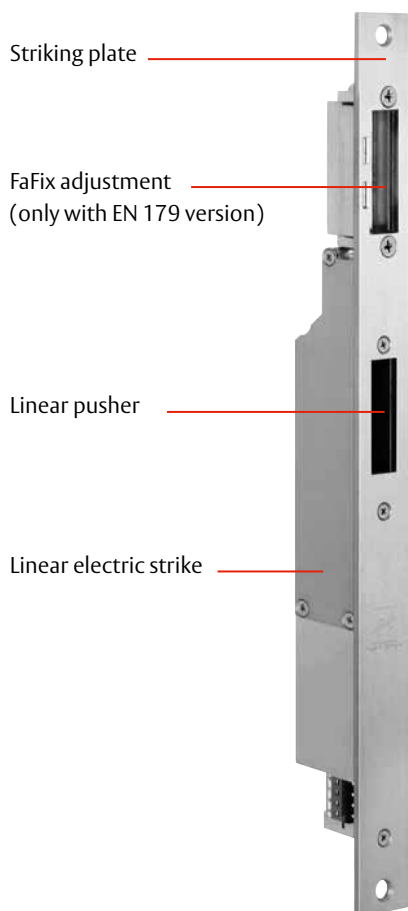

The two different  
 construction forms of  
 MEDIATOR® locks:  
 The single and multi-point  
 variants

Compatible accessories,  
 available



## Certified security.

### What certifications are there for Mediator®?

#### Approval for fire and smoke protection doors

The basic requirement for use in fire or smoke protection doors is a general test certificate from inspection authorities.

The test certificate number for MEDIATOR® is 120003555.

The general inspection authority test certificate is required by the door manufacturer for the certification of the door system. Only then is it possible for the door manufacturer to certify (door system certification) and produce a fire or smoke protection door.

#### The following must be observed for use in fire and smoke protection doors:

- The MEDIATOR® solution may only be installed during production by the door manufacturer and with a corresponding door system certification. Retrofitting in an existing fire or smoke protection door is not permitted, or only after obtaining approval from the door manufacturer.
- The MEDIATOR® electric strike must bear conformity marking (models from 09/2008 and later) and must also use the fire module 519ZBFS. For triggering in the event of a fire, a local fire alarm system or a smoke detector with relay output e.g. model 60060 + 92020---10 must be used (see connection diagram on page 39).
- A permanent unlocking of the MEDIATOR® system is not permitted for this application.

#### VdS approval

The MEDIATOR® has three different VdS approvals:

- Approval as lock monitoring means (bolt switch contact) VdS Class C, G 109 032
- Approval as a mechanical lock VdS Class A, M 109 314
- Approval as an electromechanical actuator for access control systems VdS Class C, Z 109 001



#### Approval according to DIN EN 179 and EN 1125

The following applies for the planning of escape doors: Prior to the call for bid, it must be determined whether emergency or panic doors are involved. The legal basis for this is the applicable building code with the corresponding special building regulations.

The decision for emergency or panic doors must be based on EN standards 179 and 1125 with uniform applicability throughout Europe since April of 2003. The two standards differentiate between emergency exit (DIN EN 179) and panic exit (DIN EN 1125) and thereby regulate the corresponding equipment of the door.

DIN EN 179 (emergency exit door lock)  
EC Certificate of Conformity 0432 CPD-0001

DIN EN 1125 (panic door lock)  
EC Certificate of Conformity 0432 CPD-0017

vds

## Checklist for retrofitting.

### What must be taken into consideration?

In order to ensure that MEDIATOR functions perfectly:

Survey on the main entrance.

MEDIATOR® is ingenious and therefore very straightforward. Easy to use on a daily basis and just as easy to install. In order for the lock solution to work perfectly as well, a few factors must be taken into consideration before ordering. This pertains to the existing entrance door and its lock and strike. And thus also selection of the required MEDIATOR® components.

The following checklist for door features ensures security for your door.

- 1 DIN handing**  DIN left  DIN right
- 2 Backset**  
 Tubular frame version  30 mm  35 mm  40 mm  45 mm  
 Wooden and steel version  55 mm  60 mm  65 mm  \_\_\_\_\_ mm
- 3 Face plate**  
 Width \_\_\_\_\_ mm  
 Thickness \_\_\_\_\_ mm  
 Reworking for lock opening possible  Yes  No  
 (with multi-point locking, only 6.5 mm possible, U-shaped face plate)
- 4 Rebate gap**  
 Door frame/door leaf gap \_\_\_\_\_ mm  
 For this purpose, please refer to p. 14
- 5 Face plate / striking plate**  
 Face plate / striking plate gap \_\_\_\_\_ mm
- 6 Distance** Euro profile cylinder  
 Tubular frame version  92 mm  
 Wooden and steel version  72 mm
- 7 Follower**  8 mm  9 mm  10 mm
- 8 Striking plate**  
 Width \_\_\_\_\_ mm  
 Thickness \_\_\_\_\_ mm  
 Reworking necessary  Yes  No
- 9 Angled striking plate**  Yes  No
- 10 Fitting**  
 Compatible with lock series 609  Yes  No
- 11 Electric Strike**  
 Present  Yes  No  
 Model \_\_\_\_\_  
 At least four connection wires  Yes  No  
 Installation of additional cables possible  Yes  No  
 Cable routeing to sub-distribution  Yes  No  
 Cable routeing to distribution box  Yes  No  
 Space for mains adapter in distribution box  Yes  No  
 Other mains adapter installation possible  Yes  No

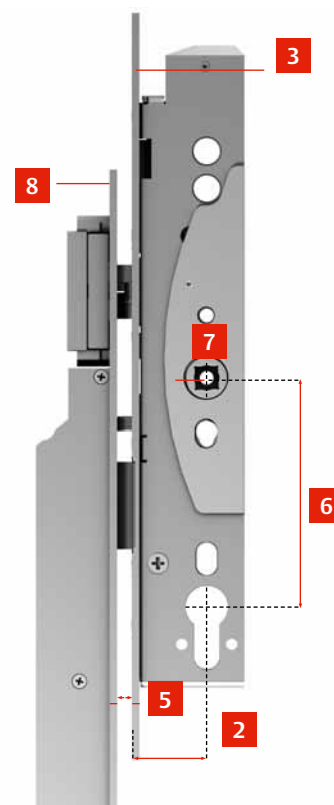

#### Please note:

- Off-size in backset/distance, alterations must be made to the door leaf on finishing.
- Space must be provided in the door frame for the motor unit.
- Possibility to align FaFix® striking plate/latch bolt.
- Required gap between face plate & striking plate after fitting: 2 – 4 mm
- Voltage supply must be allowed for.
- Four connection wires are required:
  - Two wires to voltage supply (see table)
  - Two wires to electrical actuation
- With existing connection wires, check the conductor cross-section, diameter and length and compare with the table below. If the cross-section is too small, there is insufficient current supply of the MEDIATOR® electric strike, resulting in a malfunction.

Length of line	Cross-section	Diameter
up to 10 m	0.28 mm <sup>2</sup>	0.60 mm
up to 20 m	0.50 mm <sup>2</sup>	0.80 mm
up to 30 m	0.75 mm <sup>2</sup>	-
up to 40 m	1.00 mm <sup>2</sup>	-



## Mediator® lock tubular frame version



### MEDIATOR lock, tubular frame version

The MEDIATOR® lock in its tubular frame version is available with different backsets and a comprehensive range of accessories.

#### Features:

- Self-locking system: Dead bolt and latch are blocked;  
Advantage: higher security
- Mechanical process control between cross and control latch
- Integrated panic function on the inside handle
- Changeover function for unlocking with a key from the outside
- Minimum rear backset for tubular frame design: 15 mm

MEDIATOR® locks have a bolt through the handle and thus require front door furniture (inside handle or panic push bar, outside knob or push bar).

**Fittings and accessories:** Fittings p. 20 – 23

Technical data	
<b>Backset</b> Tubular frame version	30, 35, 40, 45 mm
<b>Distance</b> Tubular frame version	Euro profile cylinder: 92 mm
Bolt throw	20 mm
Handle follower	9 mm (included in supply: reducer to 8 mm)
Approval DIN EN 179	EC Certificate of Conformity 0432 CPD-001
Approval DIN EN 1125	EC Certificate of Conformity 0432 CPD-017
VdS approval	G 109 032, M 109314, Z 109001
Building authorities test certificate	P-120003555
Mech. strength (EN 12209:2004)	200,000 cycles, 50 N load on latch, Class 6 protection

# Mediator® lock tubular frame version

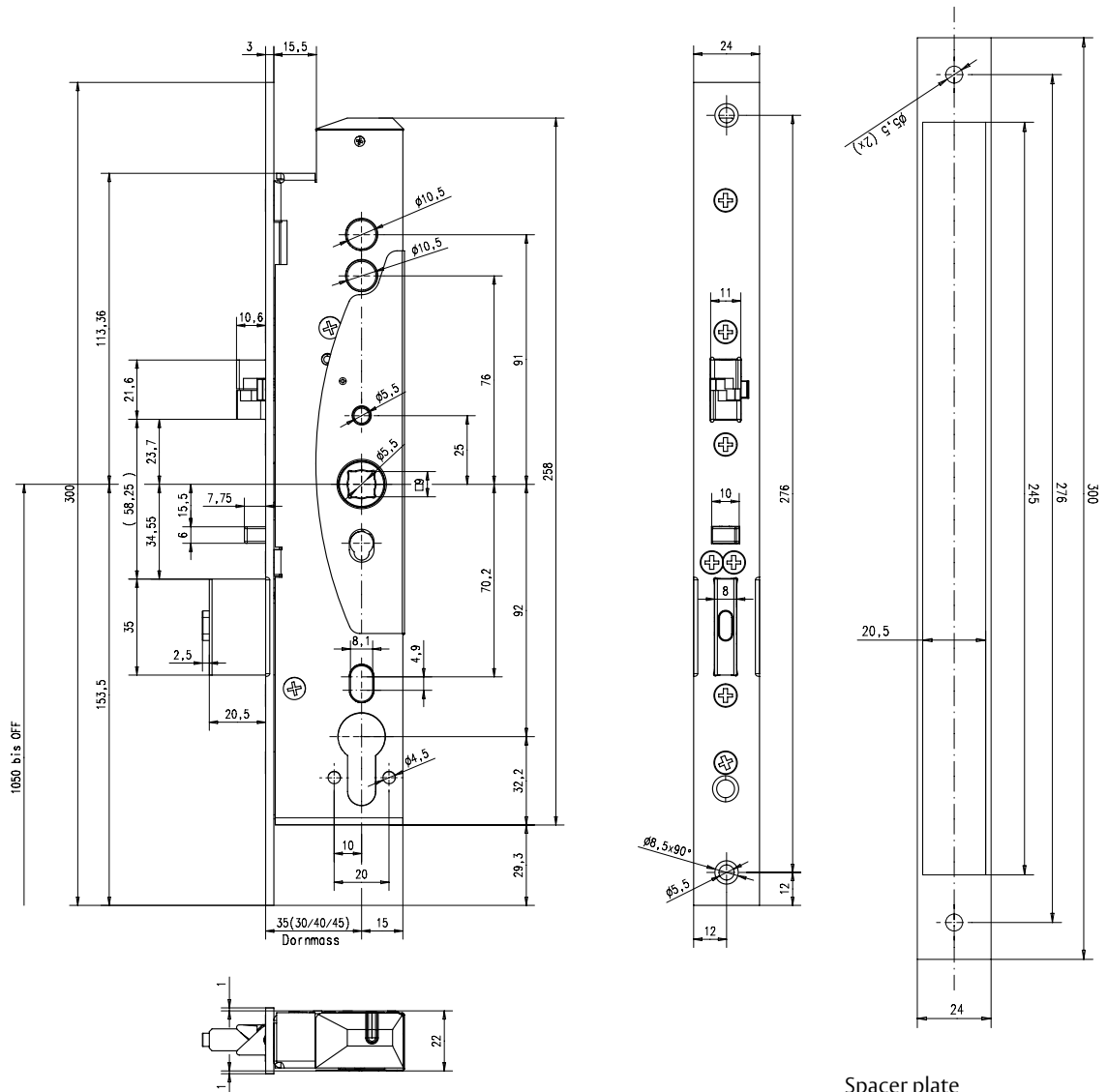

Spacer plate

## Ordering information for MEDIATOR lock, tubular frame version

### Item description

- MEDIATOR lock; face plate width 24 mm angled; distance 92 mm; Europrofile cylinder
- MEDIATOR lock; face plate width 24 mm angled; distance 92 mm; Europrofile cylinder
- MEDIATOR lock; face plate width 24 mm angled; distance 92 mm; Europrofile cylinder
- MEDIATOR lock; face plate width 24 mm angled; distance 92 mm; Europrofile cylinder

DIN	Backset, mm	Order code
1 (universal)	30	<b>609-102PZ-----1</b>
1 (universal)	35	<b>609-202PZ-----1</b>
1 (universal)	40	<b>609-302PZ-----1</b>
1 (universal)	45	<b>609-402PZ-----1</b>

### Accessories

- Spacer plate; 300 mm x 24 mm x 3 mm **Z09-DBRR3-----00**
- Spacer plate; 300 mm x 24 mm x 5 mm (without fig.) **Z09-DBRR5-----00**
- Slider piece; 100 mm x 30 mm x 3 mm (see p. 14) **6 5 . 0 0 0 1 0**





## Mediator® multi-point locking tubular frame version



### MEDIATOR multi-point locking system, tubular frame version

The MEDIATOR® multi-point lock is available with different backsets in its tubular frame version.

#### Features:

- Self-locking system: Bolt and latch are blocked;  
Advantage: Higher security
- Additional sturdy hooked bolts for improved burglary protection. The hooked bolts are not designed to apply pressure to door seals. The system will only work effectively if there is no side pressure on the bolt.
- Mechanical process control between cross and control latch
- Integrated panic function on the inside handle
- Changeover function for unlocking with a key from the outside
- Minimum rear backset for tubular frame design: 15 mm

MEDIATOR® locks have a bolt through the handle and thus require front door furniture (inside handle or panic push bar, outside knob or push bar).

**Fittings and accessories:** Fittings p. 20 – 23

Technical data	
<b>Backset</b> Tubular frame version	30, 35, 40, 45 mm
<b>Distance</b> Tubular frame version	Euro profile cylinder: 92 mm
Bolt throw	20 mm
Handle follower	9 mm (included in supply: reducer to 8 mm)
U-shaped face plate	24 x 6.5 x 1760 mm
Approval DIN EN 179	EC Certificate of Conformity 0432 CPD-001
Approval DIN EN 1125	EC Certificate of Conformity 0432 CPD-017
Building authorities test certificate	P-120003555
Mech. strength (EN 12209:2004)	200,000 cycles, 50N load on latch, Class 6 protection



**Note:**  
Take U-rail into account when planning and installing.

# Mediator® multi-point locking tubular frame version

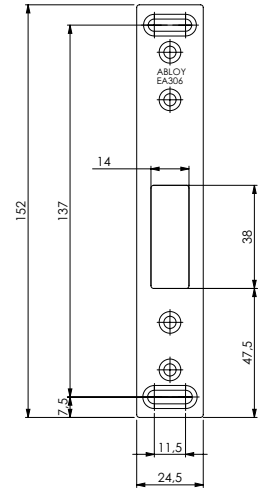
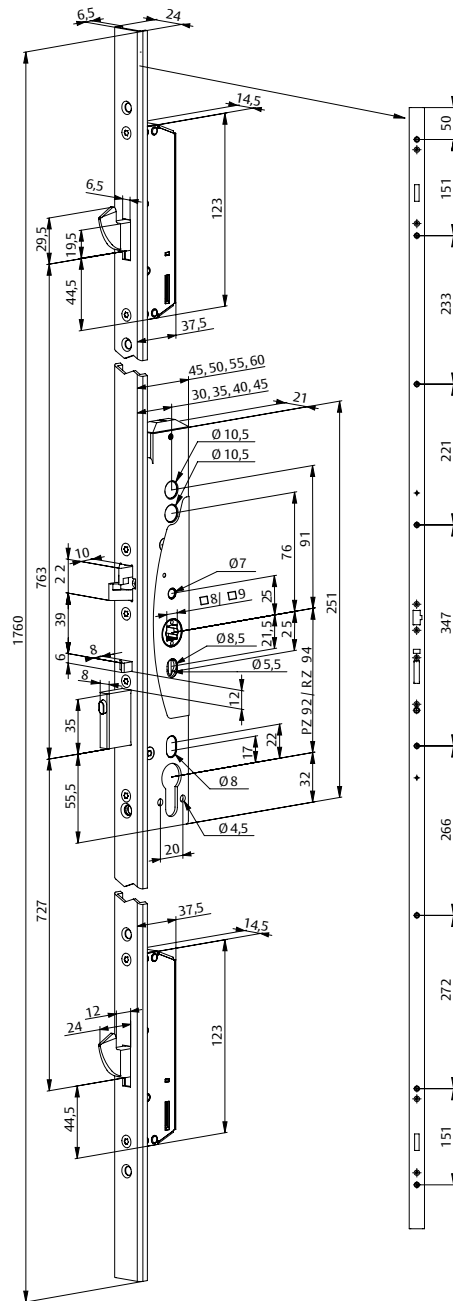

Flat striking plate

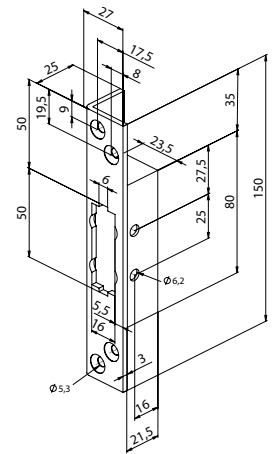

Angled striking plate

## Ordering information for MEDIATOR lock, multi-point locking, tubular frame version

Item description	DIN	Backset, mm	Order code
MEDIATOR multi-point lock; U-shaped face plate 24 x 6.5 mm; Distance 92 mm; Europrofile cyl.	1 (universal)	30	629X100PZ-----1
MEDIATOR multi-point lock; U-shaped face plate 24 x 6.5 mm; Distance 92 mm; Europrofile cyl.	1 (universal)	35	629X200PZ-----1
MEDIATOR multi-point lock; U-shaped face plate 24 x 6.5 mm; Distance 92 mm; Europrofile cyl.	1 (universal)	40	629X300PZ-----1
MEDIATOR multi-point lock; U-shaped face plate 24 x 6.5 mm; Distance 92 mm; Europrofile cyl.	1 (universal)	45	629X400PZ-----1
<b>Accessories</b>			
Flat striking plate for hooked bolts; 24.5 x 152 mm			Z29-SBL-1-----1
Spacer plate for multi-point lock motorized power cam bolt			Z65-49B35----01
Angled striking plate for hooked bolts; 25 x 27 x 150 mm			Z29-SBL-3-----1
Slider piece; 100 mm x 30 mm x 3 mm (see p. 14)			6 5 . 0 0 0 1 0



## Mediator<sup>®</sup> lock

### Wooden and steel doors version

#### MeDIATor lock, wooden and steel door version

the Mediator lock in its wooden and steel door version is available with different backsets and a comprehensive range of accessories.

#### Features:

- Self-locking system: dead bolt and latch are blocked; advantage: higher security
- Mechanical process control between cross and control latch
- integrated panic function on the inside handle
- Changeover function for unlocking with a key from the outside

Mediator locks have a bolt through the handle and thus require front door furniture (inside handle or panic push bar, outside knob or push bar).

#### Fittings and accessories available



Technical data	
<b>Backset</b> Wooden and steel doors version	55, 60, 65, 80, 100 mm
<b>Distance</b> Wooden and steel doors version	Euro profile cylinder: 72 mm
Face plate widths	20 mm / 24 mm
Bolt throw	20 mm
Handle follower	9 mm (included in supply: reducer to 8 mm)
Approval DIN EN 179	EC Certificate of Conformity 0432-CPD-001
Approval DIN EN 1125	EC Certificate of Conformity 0432-CPD-017
VdS approval	G 109 032, M 109314, Z 109001, P-120003555
Building authorities test certificate	P-120003555
Mech. strength (EN 12209:2004)	200,000 cycles, 50 N load on latch, Class 6 protection

# Mediator® lock

Wooden and steel door version, 20 mm face plate /  
24 mm face plate

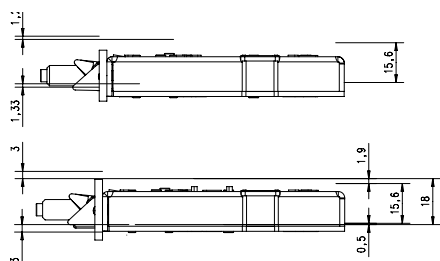
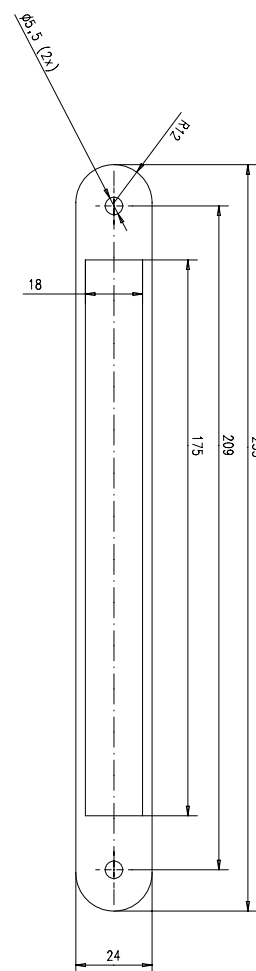
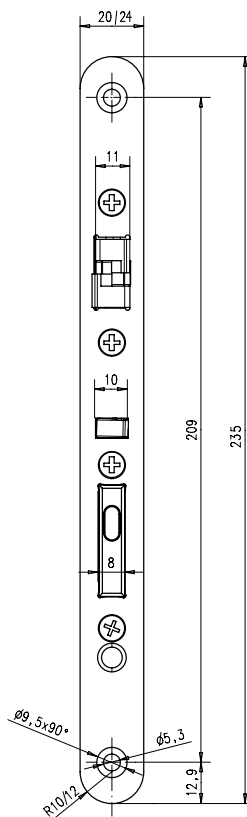
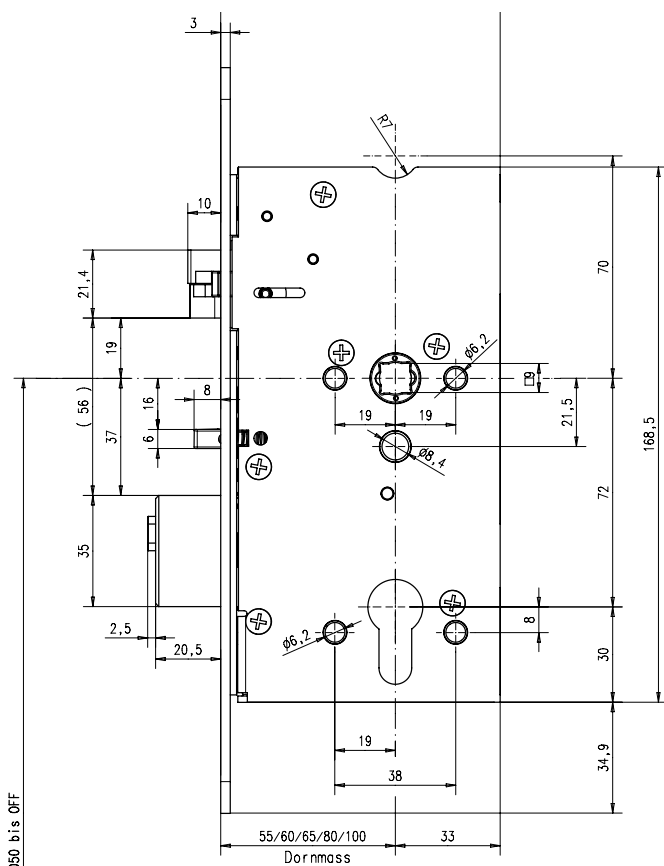

Face plate 20 mm

Face plate 24 mm

Spacer plate 24 mm

**ordering information for MeDIATor lock, wooden and steel door version, 24 mm face plate**

**Item description**

- Mediator lock; face plate width 24 mm angled; distance 72 mm; europrofile cylinder
- Mediator lock; face plate width 24 mm angled; distance 72 mm; europrofile cylinder
- Mediator lock; face plate width 24 mm angled; distance 72 mm; europrofile cylinder
- Mediator lock; face plate width 24 mm angled; distance 72 mm; europrofile cylinder
- Mediator lock; face plate width 24 mm angled; distance 72 mm; europrofile cylinder

**Accessories**

- Spacer plate; 235 mm x 24 mm x 3 mm
- Slider piece; 100 mm x 30 mm x 3 mm (see p. 14)

**DIN**

- 1 (universal)
- 1 (universal)
- 1 (universal)
- 1 (universal)
- 1 (universal)

**Backset, mm**

- 55
- 60
- 65
- 80
- 100

**order code**

- 6 0 9 - 5 0 2 P Z - - - - 1
- 6 0 9 - 6 0 2 P Z - - - - 1
- 6 0 9 - 7 0 2 P Z - - - - 1
- 6 0 9 - 8 0 2 P Z - - - - 1
- 6 0 9 - 9 0 2 P Z - - - - 1

- Z 0 9 - D B V B 3 - - - - 0 0
- 6 5 . 0 0 0 0 1 0

**ordering information for MeDIATor lock, wooden and steel door version, 20 mm face plate**

**Item description**

- Mediator lock; face plate width 20 mm angled; distance 72 mm; europrofile cylinder
- Mediator lock; face plate width 20 mm angled; distance 72 mm; europrofile cylinder
- Mediator lock; face plate width 20 mm angled; distance 72 mm; europrofile cylinder
- Mediator lock; face plate width 20 mm angled; distance 72 mm; europrofile cylinder
- Mediator lock; face plate width 20 mm angled; distance 72 mm; europrofile cylinder

**Accessories**

- Slider piece; 100 mm x 30 mm x 3 mm (see p. 14)

**DIN**

- 1 (universal)
- 1 (universal)
- 1 (universal)
- 1 (universal)
- 1 (universal)

**Backset, mm**

- 55
- 60
- 65
- 80
- 100

**order code**

- 6 0 9 - 5 0 1 P Z - - - - 1
- 6 0 9 - 6 0 1 P Z - - - - 1
- 6 0 9 - 7 0 1 P Z - - - - 1
- 6 0 9 - 8 0 1 P Z - - - - 1
- 6 0 9 - 9 0 1 P Z - - - - 1

- 6 5 . 0 0 0 0 1 0



## Mediator® multi-point locking

### Wooden and steel doors version



#### MEDIATOR multi-point lock, wooden and steel door version

The MEDIATOR multi-point lock is available with different backsets in its wooden and steel door version.

#### Features:

- Self-locking system: Dead bolt and latch are blocked;  
Advantage: higher security
- Additional sturdy hooked bolts for improved burglary protection. The hooked bolts are not designed to apply pressure to door seals. The system will only work effectively if there is no side pressure on the bolt.
- Mechanical process control between cross and control latch
- Integrated panic function on the inside handle
- Changeover function for unlocking with a key from the outside
- Minimum rear backset for tubular frame design: 15 mm

MEDIATOR locks have a bolt through the handle and thus require front door furniture (inside handle or panic push bar, outside knob or push bar).

**Fittings and accessories:** Fittings p. 28 – 31

Technical data	
<b>Backset</b> Wooden and steel doors version	55, 60, 65, 80, 100 mm
<b>Distance</b> Wooden and steel doors version	Euro profile cylinder: 72 mm
Bolt throw	20 mm
Handle follower	9 mm (included in supply: reducer to 8 mm)
U-shaped face plate	24 x 6.5 x 1760 mm
Approval DIN EN 179	EC Certificate of Conformity 0432 CPD-001
Approval DIN EN 1125	EC Certificate of Conformity 0432 CPD-017
Building authorities test certificate	P-120003555
Mech. strength (EN 12209:2004)	200,000 cycles, 50N load on latch, Class 6 protection



**Note:**  
Take U-rail into account when planning and installing.

# Mediator® multi-point locking

## Wooden and steel doors version

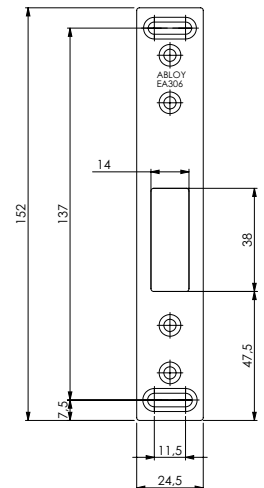
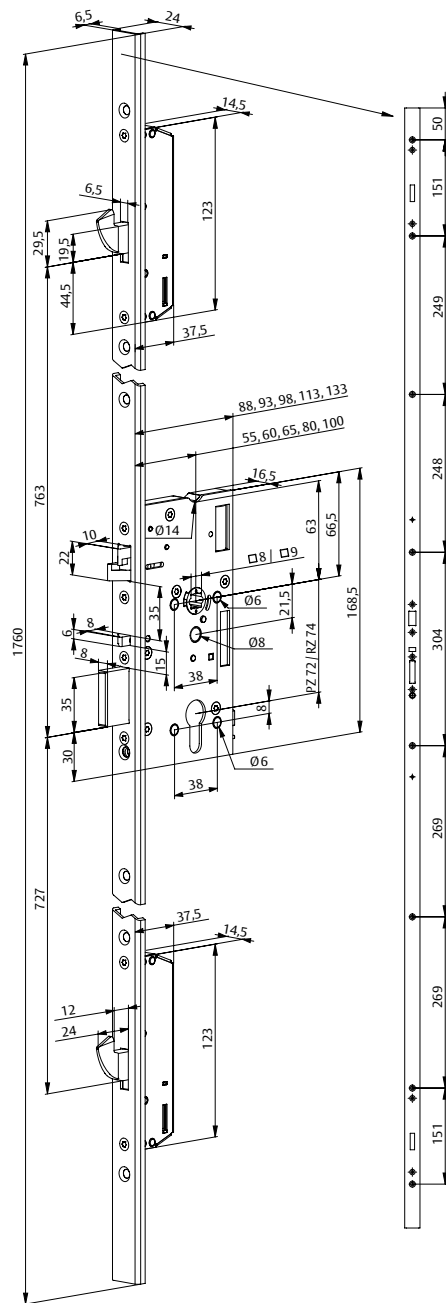

Flat striking plate

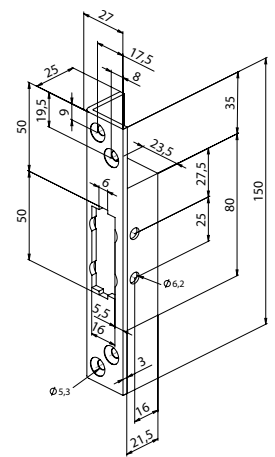

Angled striking plate

### Ordering information for MEDIATOR lock, multi-point locking, tubular frame version

Item description	DIN	Backset, mm	Order code
MEDIATOR multi-point lock; U-shaped face plate 24 x 6.5 mm; Distance 72 mm; Europrofile cyl.	1 (universal)	55	629X500PZ-----1
MEDIATOR multi-point lock; U-shaped face plate 24 x 6.5 mm; Distance 72 mm; Europrofile cyl.	1 (universal)	60	629X600PZ-----1
MEDIATOR multi-point lock; U-shaped face plate 24 x 6.5 mm; Distance 72 mm; Europrofile cyl.	1 (universal)	65	629X700PZ-----1
MEDIATOR multi-point lock; U-shaped face plate 24 x 6.5 mm; Distance 72 mm; Europrofile cyl.	1 (universal)	80	629X800PZ-----1
MEDIATOR multi-point lock; U-shaped face plate 24 x 6.5 mm; Distance 72 mm; Europrofile cyl.	1 (universal)	100	629X900PZ-----1
<b>Accessories</b>			
Flat striking plate for hooked bolts; 24.5 x 152 mm			Z29-SBL-1-----1
Spacer plate for multi-point lock motorized power cam bolt			Z65-49B35-----01
Angled striking plate for hooked bolts; 25 x 27 x 150 mm			Z29-SBL-3-----1
Slider piece; 100 mm x 30 mm x 3 mm (see p. 14)			6 5 . 0 0 0 0 1 0



## Mediator® electric strike for locks and multi-point locking

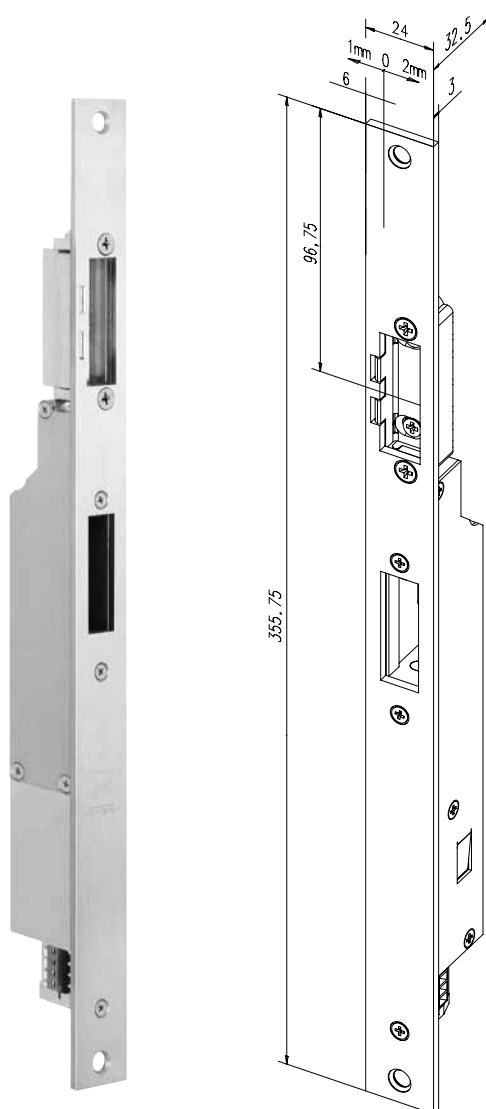

### The MEDIATOR linear electric strike for locks and multi-point locking

The MEDIATOR linear electric strike has been especially developed for this lock solution. Manufactured to effeff's established high quality standards, it is available with fix adjustment and flat, angled, arc, or renovation striking plates. Different spacer plates to align the rebate clearance are available with the striking plate used. A sliding piece is available to bridge notches and unevenness in the profile.

The MEDIATOR linear electric strike is motor-driven and fulfils all the requirements for use in busy apartment doors.

#### Note:

A different variant of MEDIATOR electric strike is required for multi-point locking (Model 65M...) The unlocking time until completely unlocked is 1.3 seconds. The dimensions of Model 65M... correspond to those of Model 65...

#### accessories:

- Spacer plate, see p. 38
- Mains adapters, see p. 36
- Sliding piece, see p. 37

Technical data	
Rated operating voltage	12 V DC (controlled DC voltage) -10% / +20%
Control voltage (release)	5 V to 48 V AC/DC
Rated current consumption	500 mA
Possible Bolt throw	20 mm
Time until complete unlocking / locking	Model 65... approx. 0.8 Sec. Model 65M... approx. 1.3 Sec.
Period of time system unlocked	3 s
Resistance to forced entry	6,000 N
Operating temperature	-20 °C to +60 °C
Spacing between faceplate and striking plate	min. 2 mm to max. 4 mm
Monitoring contact door locked/closed	Max. 30 V DC, 500 mA
Monitoring contact door unlocked/accessible	Max. 30 V DC, 500 mA
Dimensions without striking plate	206 mm x 20 mm x 29,5 mm (L x W x H)
Fix adjustment	Yes
Fix adjustment range	3 mm
Preload	Max. 80 N
Permanent release	Yes
Approval DIN EN 179	EC Certificate of Conformity 0432 CPD-001
Approval DIN EN 1125 (without Fix adjustment)	EC Certificate of Conformity 0432 CPD-017
VdS approval as lock monitoring means	Class C, G 109 032
VdS approval as an electromechanical actuator	Class C, G 109 001
VdS approval as a mechanical locking means	Class A, M 109 314

## Mediator® electric strike

### Ordering information for version dIN eN 179

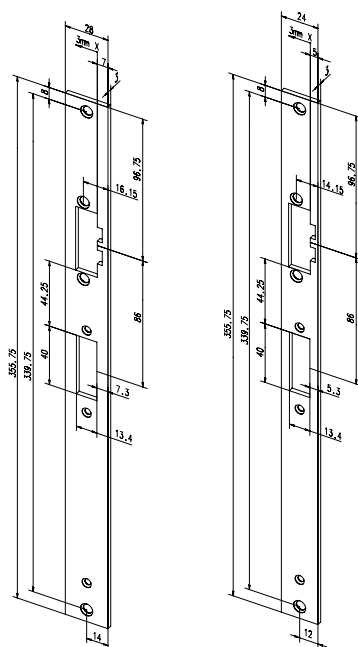
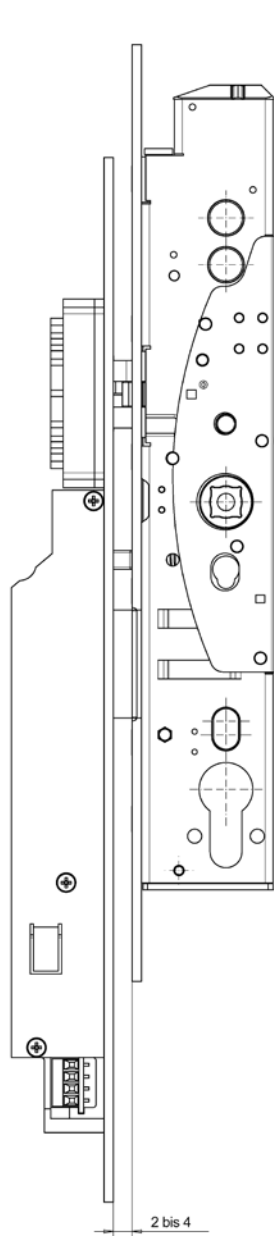

Flat striking plates

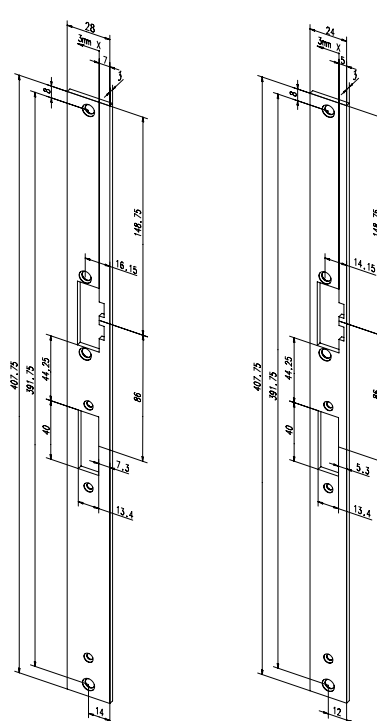

Renovation flat striking plate

#### Ordering information for MEDIATOR electric strike with striking plate for single-point locks according to DIN EN 179

Item description	Compatible Spacer plate	Thickness mm	Order code
MEDIATOR electric strike with flat striking plate DIN EN 179; 355, 75 mm x 28 mm x 3 mm	Z65-30A35----01	3	65-----30A35E91
	Z65-30B35----01	2	
MEDIATOR electric strike with flat striking plate DIN EN 179; 355.75 mm x 24 mm x 3 mm	Z65-31A35----01	3	65-----31A35E91
	Z65-31B35----01	2	
MEDIATOR electric strike with renovation flat striking plate DIN EN 179; 407.75 mm x 28 mm x 3 mm	Z65-36A35----01	3	65-----36A35E91
	Z65-36B35----01	2	
MEDIATOR electric strike with renovation flat striking plate DIN EN 179; 407.75 mm x 24 mm x 3 mm	Z65-34A35----01	3	65-----34A35E91
	Z65-34B35----01	2	

#### Ordering information for MEDIATOR electric strike with striking plate for multi-point locks according to DIN EN 179

Item description	Compatible Spacer plate	Thickness mm	Order code
MEDIATOR electric strike with flat striking plate for multi-point locks according to DIN EN 179; 355, 75 mm x 28 mm x 3 mm	Z65-30A35----01	3	65M----30A35E91
	Z65-30B35----01	2	
MEDIATOR electric strike with flat striking plate for multi-point locks according to DIN EN 179; 355.75 mm x 24 mm x 3 mm	Z65-31A35----01	3	65M----31A35E91
	Z65-31B35----01	2	
MEDIATOR electric strike with renovation flat striking plate for multi-point locking; according to DIN EN 179; 407.75 mm x 28 mm x 3 mm	Z65-36A35----01	3	65M----36A35E91
	Z65-36B35----01	2	
MEDIATOR electric strike with renovation flat striking plate for multi-point locking; according to DIN EN 179; 407.75 mm x 24 mm x 3 mm	Z65-34A35----01	3	65M----34A35E91
	Z65-34B35----01	2	



# Mediator® electric strike

## ordering information for version dIN eN 179

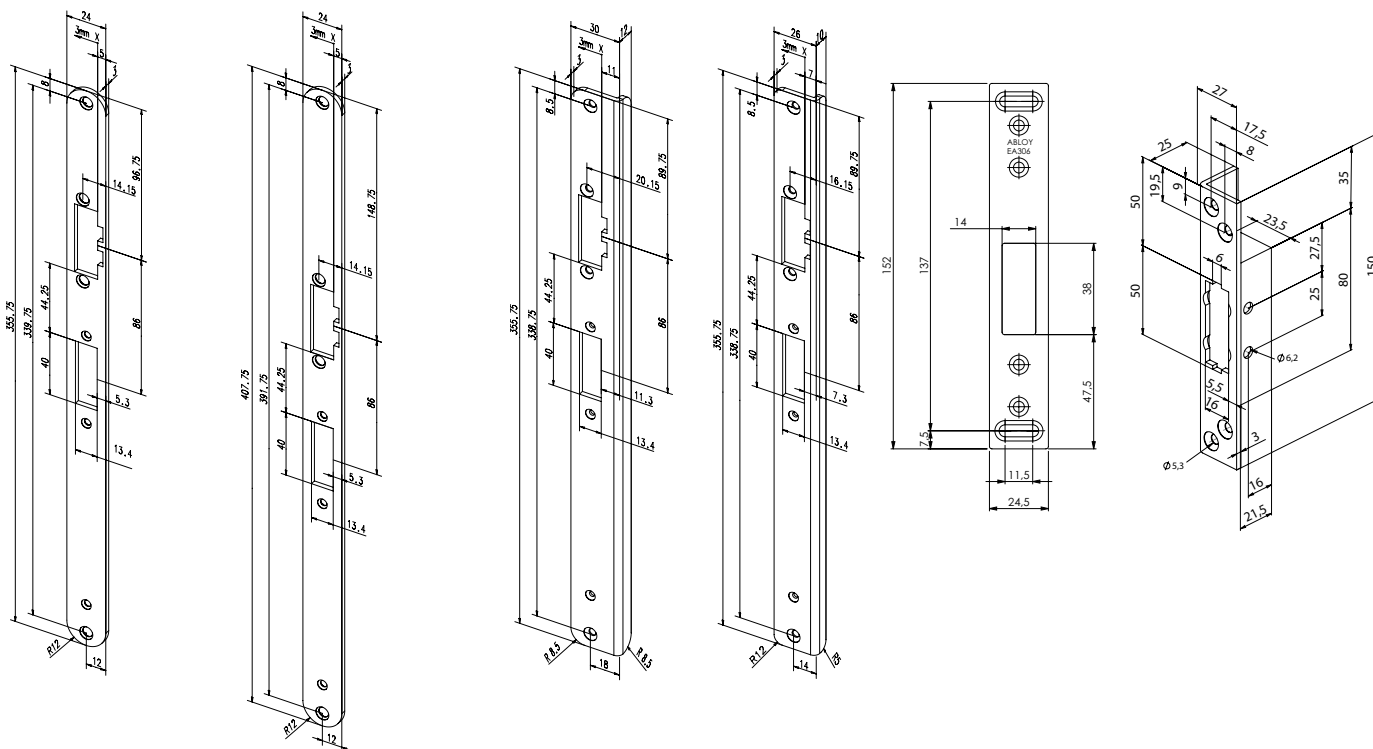

Arc striking plate and renovation arc striking plate

Striking plates for hooked bolt

### Ordering information for MEDIATOR electric strike with striking plate for single-point locks according to DIN EN 179

Item description	Compatible Spacer plate	Thickness mm	Order code
MEDIATOR electric strike with arc striking plate DIN EN 179; 355.75 mm x 24 mm x 3 mm	Z65-60A35----01 Z65-60B35----01	3 2	6 5 - - - - 6 0 A 3 5 E 9 1
MEDIATOR electric strike with renovation arc striking plate DIN EN 179; 407.75 mm x 24 mm x 3 mm	Z65-61A35----01 Z65-61B35----01	3 2	6 5 - - - - 6 1 A 3 5 E 9 1
MEDIATOR electric strike with angled striking plate according to DIN EN 179; left-hand (4), right-hand (5) 355.75 mm x 12 mm x 3 mm	---	---	6 5 - - - - 3 2 A 3 5 E 9 4 / 5
MEDIATOR electric strike with angled striking plate according to DIN EN 179; left-hand (4), right-hand (5) 355.75 mm x 12 mm x 3 mm	---	---	6 5 - - - - 3 3 A 3 5 E 9 4 / 5

### Ordering information for MEDIATOR electric strike with striking plate for multi-point locks according to DIN EN 179

Item description	Compatible Spacer plate	Thickness mm	Order code
MEDIATOR electric strike with arc striking plate DIN EN 179; 355.75 mm x 24 mm x 3 mm	Z65-60A35----01 Z65-60B35----01	3 2	6 5 M - - - - 6 0 A 3 5 E 9 1
MEDIATOR electric strike with renovation arc striking plate DIN EN 179; 407.75 mm x 24 mm x 3 mm	Z65-61A35----01 Z65-61B35----01	3 2	6 5 M - - - - 6 1 A 3 5 E 9 1
MEDIATOR electric strike with angled striking plate according to DIN EN 179; left-hand (4), right-hand (5) 355.75 mm x 12 mm x 3 mm	---	---	6 5 M - - - - 3 2 A 3 5 E 9 4 / 5
MEDIATOR electric strike with angled striking plate according to DIN EN 179; left-hand (4), right-hand (5) 355.75 mm x 12 mm x 3 mm	---	---	6 5 M - - - - 3 3 A 3 5 E 9 4 / 5

### ordering information for striking plates for multi-point locks

Item description	Compatible Spacer plate	order code
Flat striking plate for hooked bolts; 152 mm x 24.5 mm x 3 mm	Z65-49B35----01	Z 2 9 - S B L - 1 - - - - 1
Angled striking plate for hooked bolts; 25 x 27 x 150 mm	-	Z 2 9 - S B L - 3 - - - - 1



# Mediator® electric strike

## Ordering information for version d iN eN 179

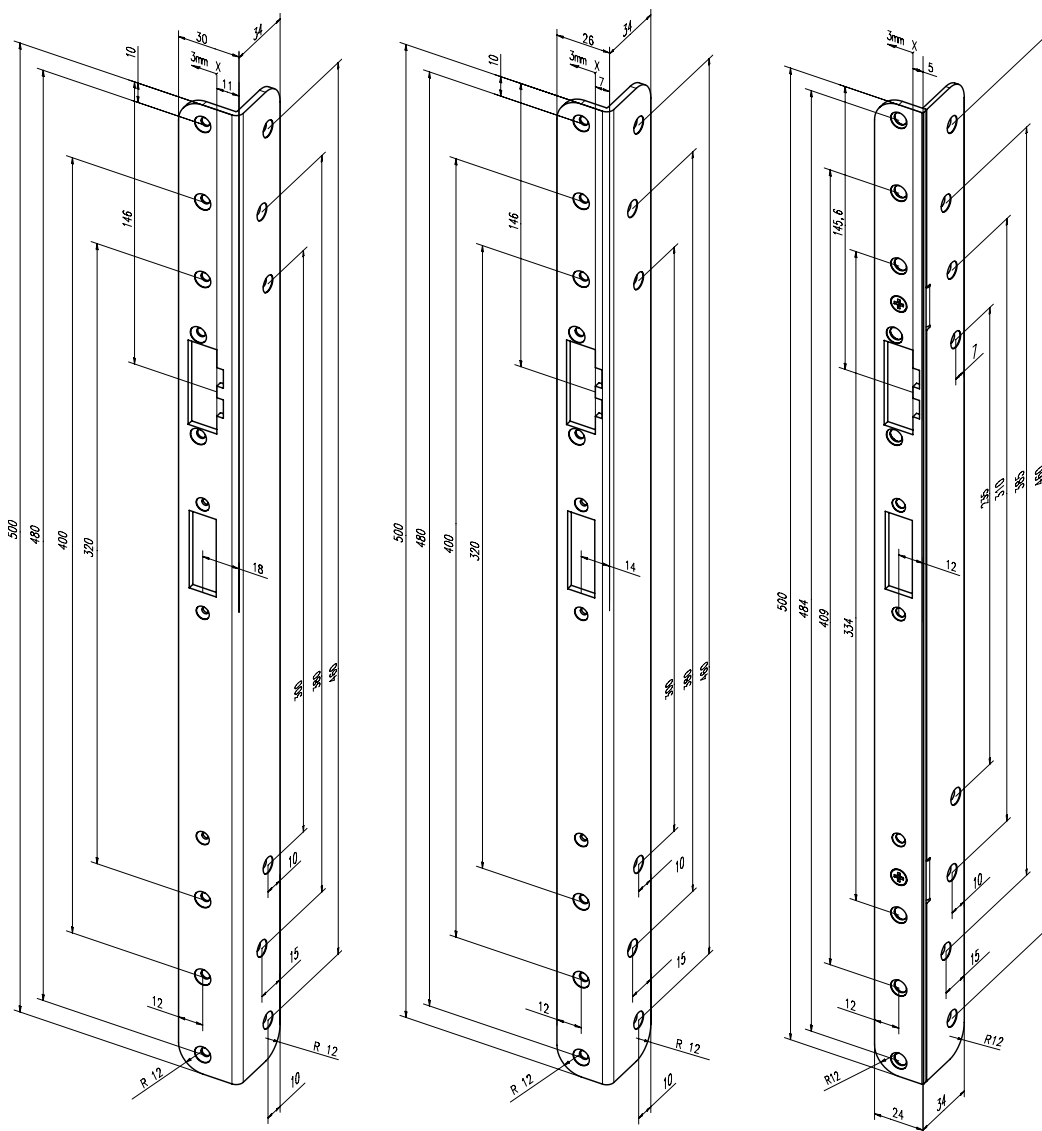

Renovation angled striking plate

The striking plate 65-----68A35E94/5 can be fit as DIN right hand/DIN left hand.

### Ordering information for MEDIATOR electric strike with striking plate for single-point locks, DIN EN 179

Item description	Compatible spacer plate	Order code
MEDIATOR electric strike with renovation angled striking, left-hand (4), right-hand (5) 500 mm x 30/34 mm x 3 mm	---	65 - - - - 64 A 3 5 E 9 4 / 5
MEDIATOR electric strike with renovation angled striking, left-hand (4), right-hand (5) 500 mm x 26/34 mm x 3 mm	---	65 - - - - 67 A 3 5 E 9 4 / 5
<del>MEDIATOR electric strike with renovation angled striking, left-hand (4), right-hand (5) 500 mm x 24/34 mm x 3 mm</del>	<del>---</del>	<del>65 - - - - 68 A 3 5 E 9 4 / 5</del>

### Ordering information for MEDIATOR electric strike with striking plate for multi-point locks, DIN EN 179

Item description	Compatible spacer plate	Order code
MEDIATOR electric strike with renovation angled striking, left-hand (4), right-hand (5) 500 mm x 30/34 mm x 3 mm	---	65 M - - - - 64 A 3 5 E 9 4 / 5
MEDIATOR electric strike with renovation angled striking, left-hand (4), right-hand (5) 500 mm x 26/34 mm x 3 mm	---	65 M - - - - 67 A 3 5 E 9 4 / 5
<del>MEDIATOR electric strike with renovation angled striking, left-hand (4), right-hand (5) 500 mm x 24/34 mm x 3 mm</del>	<del>---</del>	<del>65 M - - - - 68 A 3 5 E 9 4 / 5</del>

More striking plate variants on request



# Mediator® electric strike

## Ordering information for version dIN eN 1125

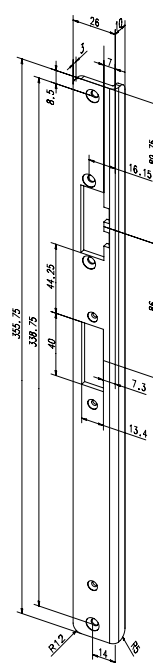
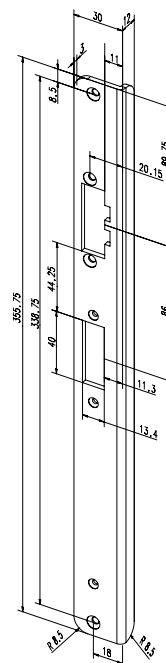
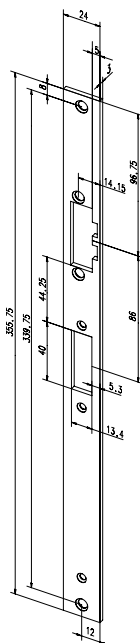
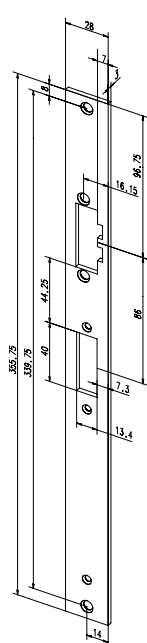
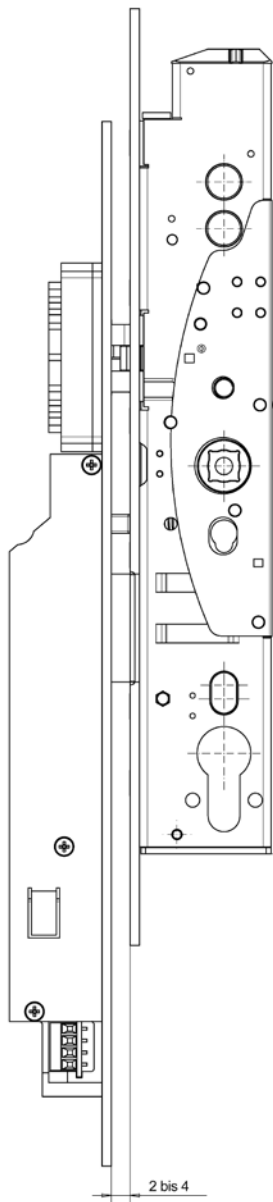

Flat striking plates

Angled striking plates

### Ordering information for MEDIATOR electric strike with striking plate for single-point locks according to DIN EN 1125

Item description	Compatible Spacer plate	Thickness mm	Order code
MEDIATOR electric strike with flat striking plate DIN EN 1125; 355.75 mm x 28 mm x 3 mm	Z65-30A35----01 Z65-30B35----01	3 2	65-P---30A35E91
MEDIATOR electric strike with flat striking plate DIN EN 1125; 355.75 mm x 24 mm x 3 mm	Z65-31A35----01 Z65-31B35----01	3 2	65-P---31A35E91
MEDIATOR electric strike with angled striking plate according to DIN EN 1125; left-hand (4), right-hand (5) 355.75 mm x 30/12 mm x 3 mm	---	---	65-P---32A35E94/5
MEDIATOR electric strike with angled striking plate according to DIN EN 1125; left-hand (4), right-hand (5) 355.75 mm x 26/12 mm x 3 mm	---	---	65-P---33A35E94/5

### Ordering information for MEDIATOR electric strike with striking plate for multi-point locks according to DIN EN 1125

Item description	Compatible Spacer plate	Thickness mm	Order code
MEDIATOR electric strike with flat striking plate for multi-point locking; according to DIN EN 1125; 355.75 mm x 28 mm x 3 mm	Z65-30A35----01 Z65-30B35----01	3 2	65MP---30A35E91
MEDIATOR electric strike with flat striking plate for multi-point locking; according to DIN EN 1125; 355.75 mm x 24 mm x 3 mm	Z65-31A35----01 Z65-31B35----01	3 2	65MP---31A35E91
MEDIATOR electric strike with angled striking plate according to DIN EN 1125; left-hand (4), right-hand (5) 355.75 mm x 30/12 mm x 3 mm	---	---	65MP---32A35E94/5
MEDIATOR electric strike with angled striking plate according to DIN EN 1125; left-hand (4), right-hand (5) 355.75 mm x 26/12 mm x 3 mm	---	---	65MP---33A35E94/5

Note:  
With use in accordance with dIN eN 1125, no adjustable latch components may be used!

